

# VINYL GRAPHICS APPLICATION INSTRUCTIONS

## Tools Required:

Tape measure, plastic squeegee, masking tape

*It is highly recommended that a professional sign/decals installer be used for applying any graphics. If you choose, however, to do it yourself please follow these directions.*

**A**

Position graphic onto the wall or window. Use a tape measure to make sure the graphic is centered and level. Use strips of masking tape in the corners to hold in place.



**B**

When decal is taped into position, put a long strip of tape across the top or bottom to create a "hinge".



**C**

Remove strips of tape on the opposite side of "hinge". Flip graphic over on the "hinge" and carefully peel the liner paper off the back revealing the adhesive side of the decal.

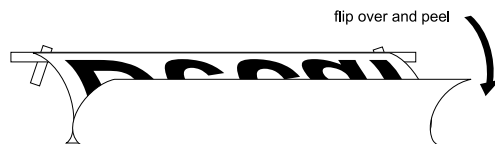

**D**

After the paper liner has been peeled off, grab the loose corners of the graphic and flip it back over onto the wall or glass surface. When doing this, pull on the corners tightly so that the graphic remains flat during application. Press the corners down to keep the graphic in position. **DO NOT SMOOTH THE GRAPHIC DOWN WITH YOUR HANDS.**

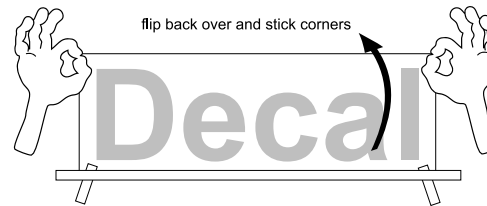

**E**

There will be a very thin layer of air trapped between the decal and the surface. This prevents the decal from sticking permanently to the surface. Use a plastic squeegee or another thin, rigid piece of plastic to work the air out. Start from the center of the graphic, at the "hinge", and firmly glide the squeegee to the opposite end of the decal. Repeat the process while moving to one side of the decal, then to the other. Overlap each stroke. Working the graphic in this manner will help prevent air bubbles from getting trapped between the decal and the surface.

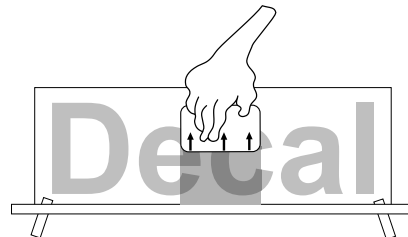

**F**

After smoothing down the graphic, begin peeling the application tape away from the decal. Pull downward on the tape so that it's flat against the graphic. Do not peel outward towards your body as this may pull the decal away from the wall. Peel away remaining masking tape and you're decal installation is complete. Good job!

